

FLAT FACE/SCREW/FLANGED

VITE VALVOLA PIANA FLANGIATO
 FLANGED FLAT FACE SCREW COUPLINGS
 GEFLANSCHTE FLACHDICHTENDE
 SCHRAUBKUPPLUNGEN
 COUPLEURS FACE PLANE À VISSER BRIDÉS

Caratteristiche tecniche I

- Intercambiabilità: disegno esclusivo Dnp
- Occlusione: faccia piana
- Aggancio: a vite
- Materiale: acciaio
- Finitura: Zn-Fe (Cr III) e Zn-Ni
- Connessione: Flange SAE 6000
- Guarnizioni standard: NBR e PU
- Temperatura d'esercizio: -25 °C +100 °C
- Guarnizioni opzionali: FKM, EPDM o altro.
- Pressioni di esercizio: 300-350 bar
- Connessione in pressione residua: consentita (lato maschio o lato femmina)

Technical data E

- Interchange: exclusive Dnp profile
- Occlusion: flat face
- Locking: screw
- Material: steel
- Finishing: Zn-Fe (Cr III) and Zn-Ni
- Connection: SAE 6000 flanges
- Standard seals: NBR and PU
- Working temperature: -25 °C +100 °C
- Optional seals: FKM, EPDM or more.
- Working pressure: 300-350 bar
- Connection under residual pressure: allowed (both male or female side)

Technische Merkmale D

- Austauschbarkeit: laut exclusive Dnp Zeichnung
- Verschluss: flachdichtend
- Kupplung: Schraubweise
- Werkstoff: Stahl
- Ausführung: Zn-Fe (Cr III) und Zn-Ni
- Anschluss: SAE 6000-Flansche
- Standard-Dichtungen: NBR und PU
- Betriebstemperatur: -25 °C +100 °C
- Dichtungen nach Wahl: FKM, EPDM, usw.
- Betriebsdruck: 300-350 bar
- Kuppeln unter Restdruck: erlaubt (Steckerseite oder Muffenseite)

Caracteristiques techniques F

- Interchangeabilité: projet exclusif Dnp
- Obturation: clapet plat
- Accrochage: à visser
- Matériel: acier
- Traitement: Zn-Fe (Cr III) et Zn-Ni
- Connexion: SAE 6000 brides
- Joints standard: NBR et PU
- Température de service: -25 °C +100 °C
- Joints facultatifs: FKM, EPDM, ect.
- Pression de service: 300-350 bar
- Connexion sous pression résiduelle: possible (côté male ou femelle)

Nominal size				Max working pressure MPa	Rated flow l/min	Max flow rate l/min	Min burst pressure			Fluid spillage cc
DNP	BG	ISO	mm				Male MPa	Female MPa	Coupled MPa	
20	3	12.5	10.7	35	45	90	140	160	140	0.012
22	4A	16	12.8	35	74	150	130	130	130	0.015
25	4	19	14.8	35	100	200	130	140	130	0.020
30	5	25	17.6	35	189	280	130	130	130	0.030
35	6	31.5	26	35	288	480	140	130	140	0.040
39	7	40	30	30	379	700	130	120	130	0.050

1 MPa = 145.04 psi • 1 l = 0.264 gal

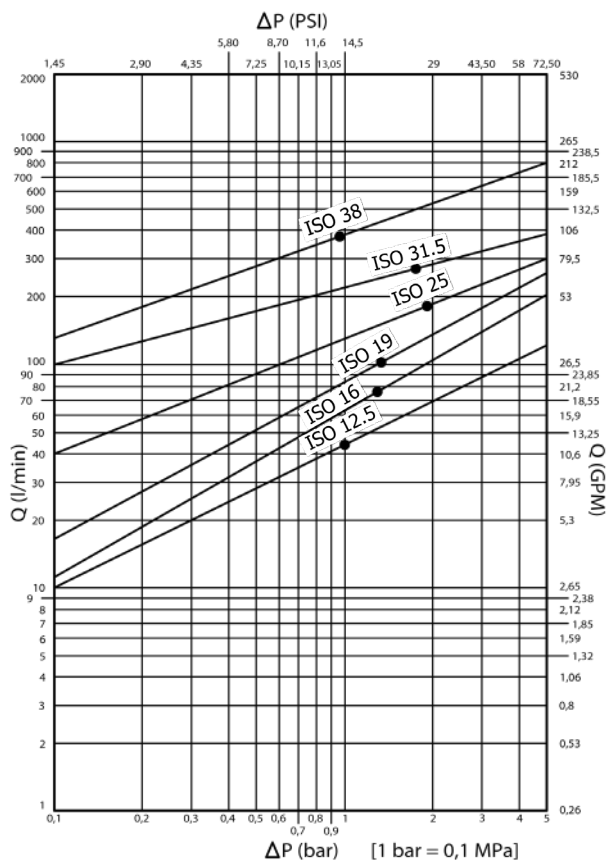

PVTF DN20 - BG 3 - ISO 12.5

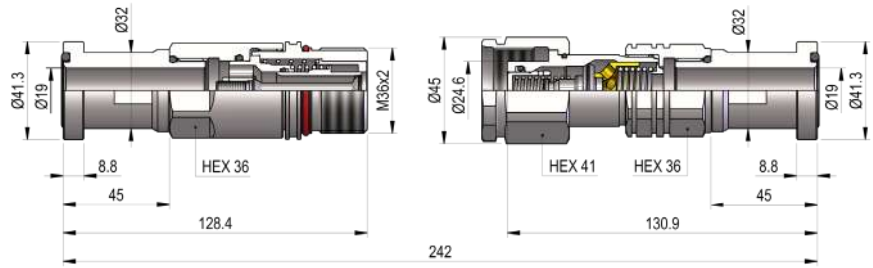

SIZE	STANDARD	FEMMINA - FEMALE - MUFFE - FEMELLE			MASCHIO - MALE - STECKER - MALE		
		COD. F	Weight (g)	Packaging (pcs.)	COD. M	Weight (g)	Packaging (pcs.)
3/4"	SAE J518	PVTF.2027.802	750	15	PVTF.2027.803	720	15

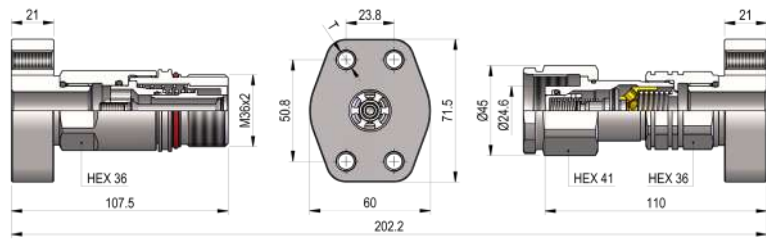

T	SIZE	STANDARD	FEMMINA - FEMALE - MUFFE - FEMELLE			MASCHIO - MALE - STECKER - MALE		
			COD. F	Weight (g)	Packaging (pcs.)	COD. M	Weight (g)	Packaging (pcs.)
M10	3/4"	SAE J518	PVTF.2027.812	1005	10	PVTF.2027.813	970	10
3/8"-16 UNC	3/4"	SAE J518	PVTF.2027.822	1005	10	PVTF.2027.823	970	10

PVTF DN22 - BG 4A - ISO 16

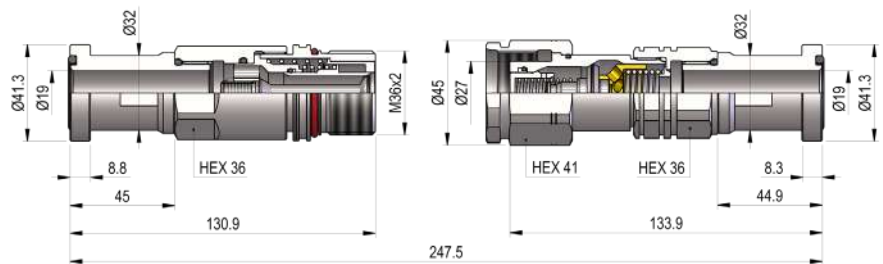

SIZE	STANDARD	FEMMINA - FEMALE - MUFFE - FEMELLE			MASCHIO - MALE - STECKER - MALE		
		COD. F	Weight (g)	Packaging (pcs.)	COD. M	Weight (g)	Packaging (pcs.)
3/4"	SAE J518	PVTF.2227.802	745	15	PVTF.2227.803	730	15

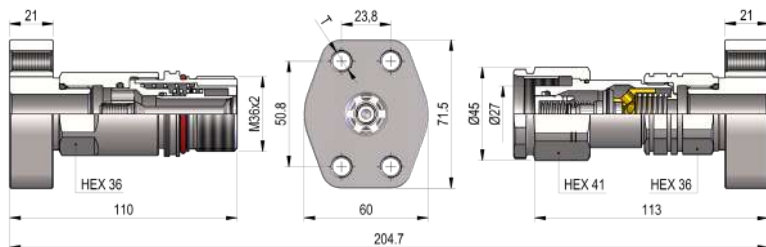

T	SIZE	STANDARD	FEMMINA - FEMALE - MUFFE - FEMELLE			MASCHIO - MALE - STECKER - MALE		
			COD. F	Weight (g)	Packaging (pcs.)	COD. M	Weight (g)	Packaging (pcs.)
M10	3/4"	SAE J518	PVTF.2227.812	995	10	PVTF.2227.813	980	10
3/8"-16 UNC	3/4"	SAE J518	PVTF.2227.822	995	10	PVTF.2227.823	980	10

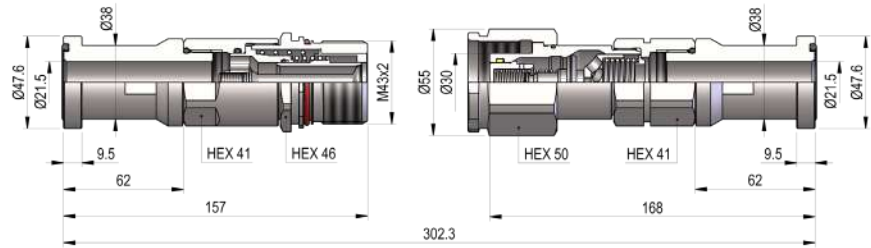
PVTF DN25 - BG 4 - ISO 19

SIZE	STANDARD	FEMMINA - FEMALE - MUFFE - FEMELLE			MASCIO - MALE - STECKER - MALE		
		COD. F	Weight (g)	Packaging (pcs.)	COD. M	Weight (g)	Packaging (pcs.)
1"	SAE J518	PVTF.2533.802	1200	12	PVTF.2533.803	1200	12

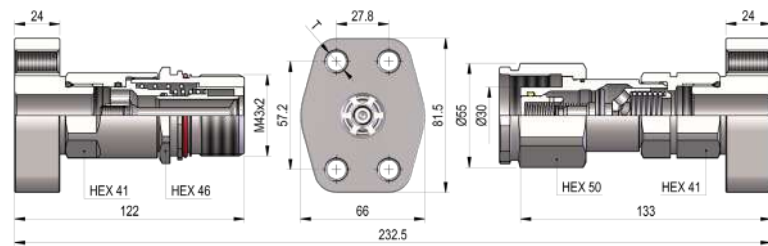

T	SIZE	STANDARD	FEMMINA - FEMALE - MUFFE - FEMELLE			MASCIO - MALE - STECKER - MALE		
			COD. F	Weight (g)	Packaging (pcs.)	COD. M	Weight (g)	Packaging (pcs.)
M12	1"	SAE J518	PVTF.2533.812	1480	8	PVTF.2533.813	1480	8
	7/16"-14 UNC	SAE J518	PVTF.2533.822	1480	8	PVTF.2533.823	1480	8

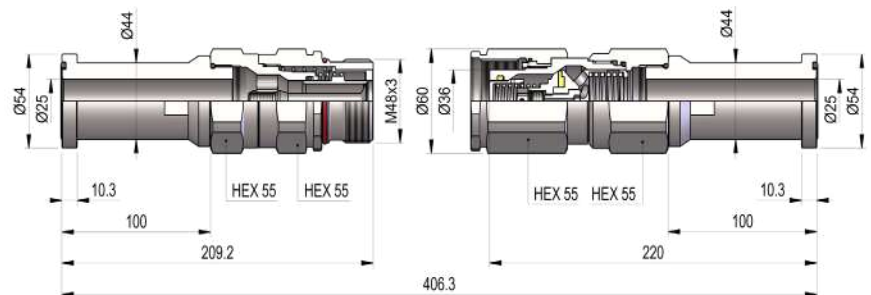
PVTF DN30 - BG 5 - ISO 25

SIZE	STANDARD	FEMMINA - FEMALE - MUFFE - FEMELLE			MASCIO - MALE - STECKER - MALE		
		COD. F	Weight (g)	Packaging (pcs.)	COD. M	Weight (g)	Packaging (pcs.)
1"¼	SAE J518	PVTF.3041.802	2250	8	PVTF.3041.803	2440	6

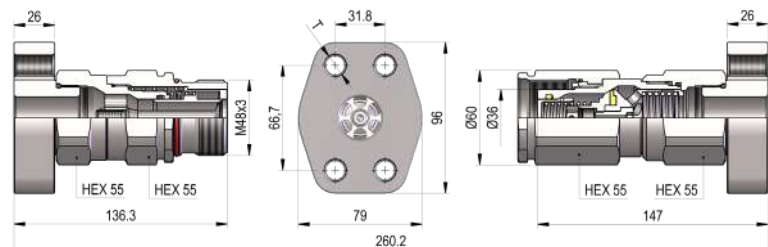

T	SIZE	STANDARD	FEMMINA - FEMALE - MUFFE - FEMELLE			MASCIO - MALE - STECKER - MALE		
			COD. F	Weight (g)	Packaging (pcs.)	COD. M	Weight (g)	Packaging (pcs.)
M14	1"¼	SAE J518	PVTF.3041.812	2390	5	PVTF.3041.813	2575	5
	1/2"-13 UNC	SAE J518	PVTF.3041.822	2390	5	PVTF.3041.823	2575	5

PVTF DN35 - BG 6 - ISO 31.5

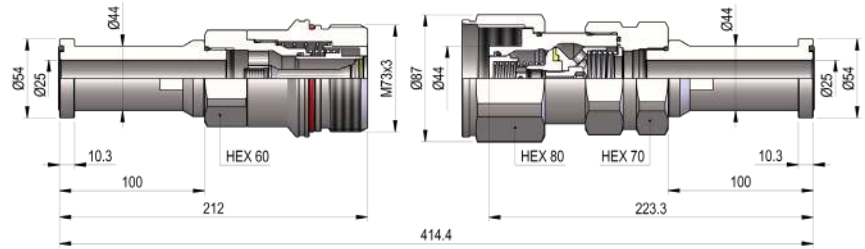

SIZE	STANDARD	FEMMINA - FEMALE - MUFFE - FEMELLE			MASCIO - MALE - STECKER - MALE		
		COD. F	Weight (g)	Packaging (pcs.)	COD. M	Weight (g)	Packaging (pcs.)
1"¼	SAE J518	PVTF.3541.802	3310	4	PVTF.3541.803	3900	4

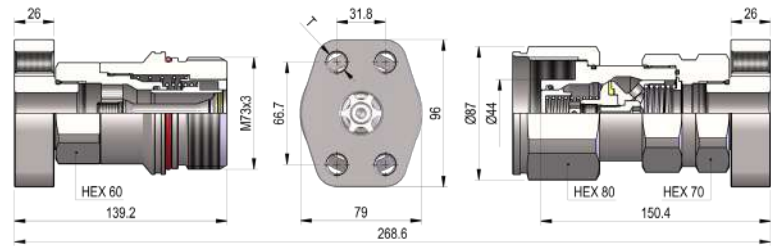

T	SIZE	STANDARD	FEMMINA - FEMALE - MUFFE - FEMELLE			MASCIO - MALE - STECKER - MALE		
			COD. F	Weight (g)	Packaging (pcs.)	COD. M	Weight (g)	Packaging (pcs.)
M14	1"¼	SAE J518	PVTF.3541.812	3445	3	PVTF.3541.813	4035	3
1/2"-13 UNC	1"¼	SAE J518	PVTF.3541.822	3445	3	PVTF.3541.823	4035	3

PVTF DN39 - BG 7 - ISO 40

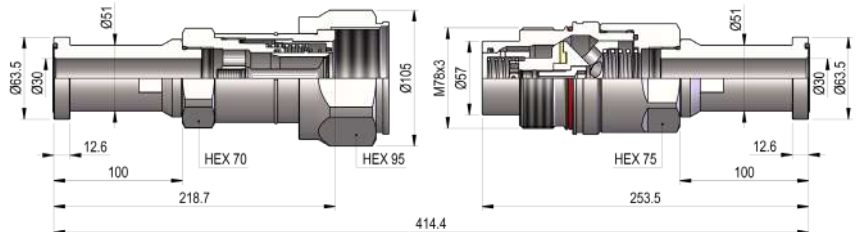

SIZE	STANDARD	FEMMINA - FEMALE - MUFFE - FEMELLE			MASCIO - MALE - STECKER - MALE		
		COD. F	Weight (g)	Packaging (pcs.)	COD. M	Weight (g)	Packaging (pcs.)
1"½	SAE J518	PVTF.3947.802	5160	2	PVTF.3947.803	5090	2

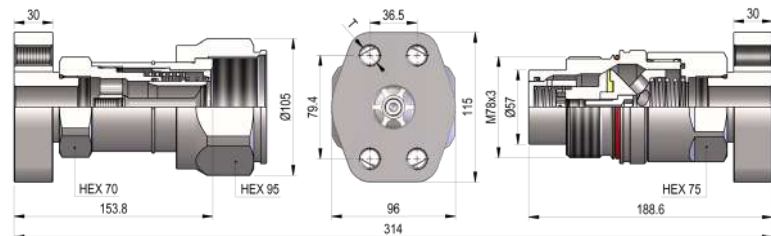

T	SIZE	STANDARD	FEMMINA - FEMALE - MUFFE - FEMELLE			MASCIO - MALE - STECKER - MALE		
			COD. F	Weight (g)	Packaging (pcs.)	COD. M	Weight (g)	Packaging (pcs.)
M16	1"½	SAE J518	PVTF.3947.812	5550	1	PVTF.3947.813	5470	1
5/8"-11 UNC	1"½	SAE J518	PVTF.3947.822	5550	1	PVTF.3947.823	5470	1

PLASTIC CAPS

NOMINAL SIZE			FEMALE DUST PLUG						MALE DUST CAP						COLOR	MATERIAL
DNP	BG	ISO	COD. F	Dimensions			Weight (g)	COD. M	Dimensions			Weight (g)				
				D	L	D1			D	L	D1					
20	3	12.5	SPVT.20002	45	220	32	48	SPVT.20003	45	220	32	48	●	PVC		
22	4A	16	SPVT.20002	45	220	32	48	SPVT.20003	45	220	32	48	●	PVC		
25	4	19	SPVT.25002	53	290	47.5	72	SPVT.25003	48	290	47.5	74	●	PVC		
30	5	25	SPVT.30002	60	438	47.5	94	SPVT.30003	60	438	47.5	91	●	PVC		

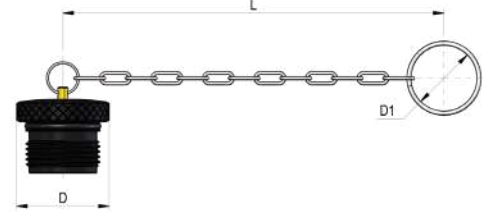
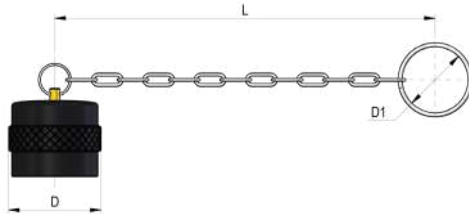
METAL CAPS

NOMINAL SIZE			FEMALE DUST PLUG						MALE DUST CAP						MATERIAL
DNP	BG	ISO	COD. F	Dimensions			Weight (g)	COD. M	Dimensions			Weight (g)			
				D	L	D1			D	L	D1				
20	3	12.5	SPVV.13202	41.5	205	32	59	SPVV.13203	41.5	205	32	66	Aluminum		
22	4A	16	SPVV.13202	41.5	205	32	59	SPVV.13203	41.5	205	32	66	Aluminum		
25	4	19	SPVT.25202	49.5	275	47.5	84	SPVT.25203	48	275	47.5	115	Aluminum		
30	5	25	SPVT.30202	54.5	275	47.5	94	SPVT.30203	58	275	47.5	113	Aluminum		
35	6	31.5	SPVT.35202	79.5	275	47.5	179	SPVT.35203	87	275	47.5	353	Aluminum		
39	7	40	SPVT.39202	90	275	47.5	269	SPVT.39203	90	275	47.5	380	Aluminum		

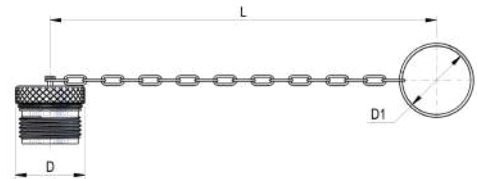
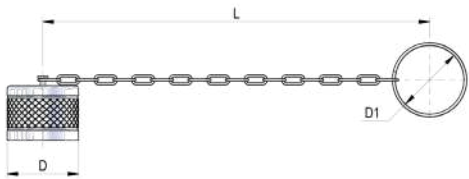
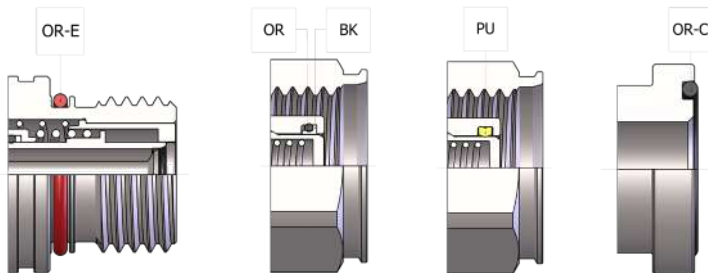
SPARE PARTS

NOMINAL SIZE			FEMALE GASKET	MALE GASKET	MALE GASKET	FLANGE GASKET	
DNP	BG	ISO	OR-E (SILICONE)	OR (NBR)	BK (PTFE)	PU (POLYURETHANE)	OR-C (NBR)
20	3	12.5	PVT.019.121 S	PLT.019.120	PLT.019.130	PVT.019.210	SAE.020.120
22	4A	16	PVT.019.121 S	PLT.022.120	PLT.022.130	PVT.022.210	SAE.020.120
25	4	19	PVT.025.121 S	PLT.025.120	PLT.025.130	PVT.025.210	PGR.025.120
30	5	25	PVT.030.121 S	PLT.031.120	PLT.031.130	PVT.030.210	PBV.025.120
35	6	31.5	PVT.035.121 S	PLS.025.120	PLT.035.130	-	PBV.025.120
39	7	40	PVT.039.121 S	PLT.039.120	PLT.039.130	-	SAE.039.120