

ISO A/DECOMPRESSION

VALVOLA DECOMPRESSIONE
 DECOMPRESSION VALVE
 DEKOMPRESSIONSVENTIL
 CLAPET DECOMPRESSION

Caratteristiche tecniche I

- Norma: ISO 7241 A
- Occlusione: valvola decompressione
- Aggancio: sfere radiali
- Materiale: acciaio
- Finitura: Zn-Fe (Cr III)
- Filettature: BSP-NPT-RC-SAE
- Guarnizioni standard: NBR
- Temperatura d'esercizio: -25°C +100°C
- Guarnizioni opzionali: FKM, EPDM o altro.
- Pressioni di esercizio: 250 bar
- Connessione in pressione residua: consentita (lato maschio o lato femmina)
- Massima pressione residua: 250 bar

Technical data E

- Standard: ISO 7241 A
- Occlusion: decompression valve
- Locking: radial balls
- Material: steel
- Finishing: Zn-Fe (Cr III)
- Threads: BSP-NPT-RC-SAE
- Standard seals: NBR
- Working temperature: -25°C +100°C
- Optional seals: FKM, EPDM or more.
- Working pressure: 250 bar
- Connection under residual pressure: allowed (both male or female side)
- Max residual pressure: 250 bar

Technische Merkmale D

- Norm: ISO 7241 A
- Verschluss: Dekompressionsventil
- Verriegelung: Stahlkugeln
- Werkstoff: Stahl
- Ausführung: Zn-Fe (Cr III)
- Gewinde: BSP-NPT-RC-SAE
- Standard-Dichtungen: NBR
- Betriebstemperatur: -25°C +100°C
- Dichtungen nach Wahl: FKM, EPDM, usw.
- Betriebsdruck: 250 bar
- Kuppeln unter Restdruck: erlaubt (Steckerseite oder Muffeseite)
- Max. Restdruck: 250 bar

Caracteristiques techniques F

- Norme: ISO 7241 A
- Obturation: clapet décompression
- Accrochage: billes radiales
- Matériel: acier
- Traitement: Zn-Fe (Cr III)
- Taraudage: BSP-NPT-RC-SAE
- Joints standard: NBR
- Température de service: -25°C +100°C
- Joints facultatifs: FKM, EPDM, ect.
- Pression de service: 250 bar
- Connexion sous pression résiduelle: possible (côté male ou femelle)
- Pression restante max: 250 bar



Nominal size				Max working pressure	Rated flow	Max flow rate	Min burst pressure			Fluid spillage
DNP	BG	ISO	mm				Male	Female	Coupled	
13	3	12.5	10.5	25	45	90	100	140	120	2.7
20	4	20	15.8	25	106	190	90	150	100	9.3

1 MPa = 145.04 psi • 1 l = 0.264 gal

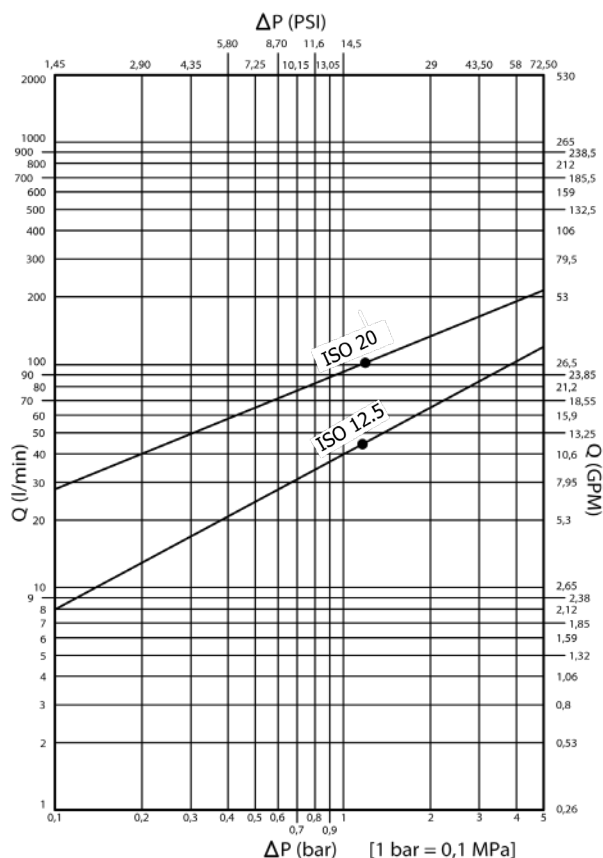

PKK1 DN13 - BG 3 - ISO 12.5

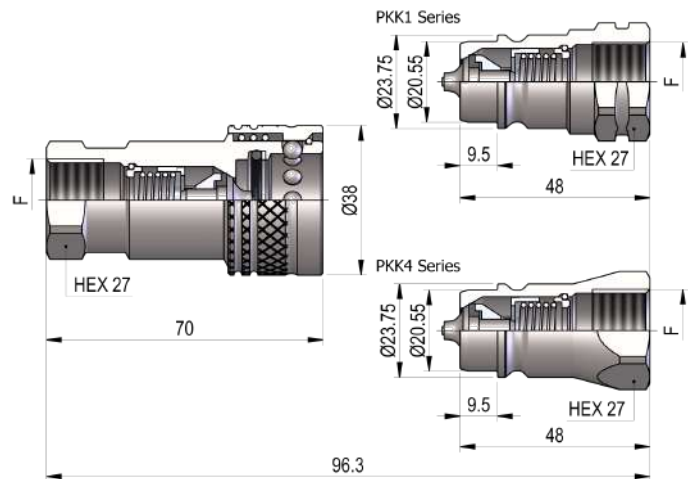

THREADS	F	STANDARD	FEMMINA - FEMALE - MUFFE - FEMELLE			MASCHIO - MALE - STECKER - MALE		
			COD. F	Weight (g)	Packaging (pcs)	COD. M	Weight (g)	Packaging (pcs)
IG 1	BSP 1/2"	DIN 3852-2-X	PKK1.1313.002	267	50	PKK1.1313.003	96	200
	BSP 1/2"	DIN 3852-2-X				PKK4.1313.003	93	200
	NPT 1/2"	ANSI B1.20.3	PKK1.1313.012	268	50	PKK1.1313.013	97	200
	Rc 1/2"	EN 10226	PKK1.1313.042	268	50	PKK1.1313.043	97	200
IG 2	M22x1.5	SAE J 2244/1	PKK1.1322.102	259	50	PKK1.1322.103	89	200
	3/4"-16 UNF 2B	SAE J 1926-1	PKK1.1319.032	273	50	PKK4.1319.033	100	200

PKK1 DN20 - BG 4 - ISO 20

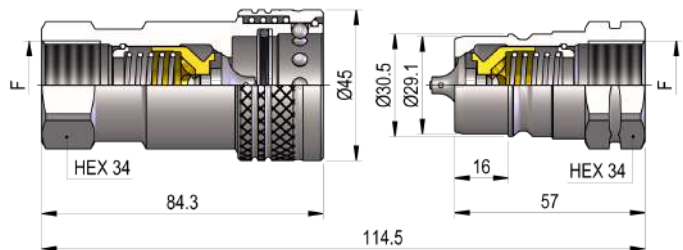

F	STANDARD	FEMMINA - FEMALE - MUFFE - FEMELLE			MASCHIO - MALE - STECKER - MALE		
		COD. F	Weight (g)	Packaging (pcs)	COD. M	Weight (g)	Packaging (pcs)
BSP 3/4"	DIN 3852-2-X	PKK1.2019.002	428	28	PKK1.2019.003	180	45
NPT 3/4"	ANSI B1.20.3	PKK1.2019.012	434	28	PKK1.2019.013	186	45
Rc 3/4"	EN 10226	PKK1.2019.042	434	28	PKK1.2019.043	186	45

THREADS

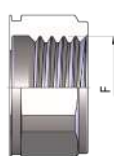

IG 1

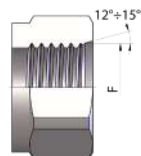

IG 2

PLASTIC CAPS

NOMINAL SIZE			FEMALE DUST PLUG					MALE DUST CAP					COLOR	MATERIAL
DNP	BG	ISO	COD. F	Dimensions			Weight (g)	COD. M	Dimensions			Weight (g)		
				D	L	D1			D	L	D1			
13	3	12.5	SPAV.13002	35	250	26	20	SPAV.13003	29	250	26	21	●	PVC
13	3	12.5	SPAV.13012	35	250	26	20	SPAV.13013	29	250	26	21	●	PVC
13	3	12.5	SPAV.13022	35	250	26	20	SPAV.13023	29	250	26	21	●	PVC
13	3	12.5	SPAV.13032	35	250	26	20	SPAV.13033	29	250	26	21	●	PVC
13	3	12.5	SPAV.13042	35	250	26	20	SPAV.13043	29	250	26	21	●	PVC
13	3	12.5	SPAV.13052	35	250	26	20	SPAV.13053	29	250	26	21	○	PVC
13	3	12.5	SPAV.13062	35	250	26	20	SPAV.13063	29	250	26	21	●	PVC
20	4	20	SPAV.20002	42	270	36	33	SPAV.20003	36.5	270	36	39	●	PVC
20	4	20	SPAV.20012	42	270	36	33	SPAV.20013	36.5	270	36	39	●	PVC
20	4	20	SPAV.20032	42	270	36	33	SPAV.20033	36.5	270	36	39	●	PVC
20	4	20	SPAV.20042	42	270	36	33	SPAV.20043	36.5	270	36	39	●	PVC
20	4	20	SPAV.20052	42	270	36	33	SPAV.20053	36.5	270	36	39	○	PVC
20	4	20	SPAV.20062	42	270	36	33	SPAV.20063	36.5	270	36	39	●	PVC

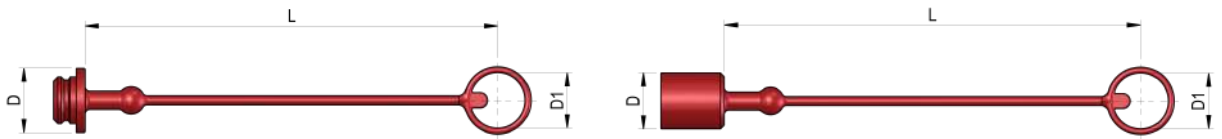

NOMINAL SIZE			FEMALE DUST PLUG					MALE DUST CAP					COLOR	MATERIAL
DNP	BG	ISO	COD. F	Dimensions			Weight (g)	COD. M	Dimensions			Weight (g)		
				D	L	D1			D	L	D1			
13	3	12.5	SPAV.13002 KR	37.5	190	29	14	SPAV.13003 KR	29.5	195	27	19	●	PVC
13	3	12.5	SPAV.13012 KR	37.5	190	29	14	SPAV.13013 KR	29.5	195	27	19	●	PVC
13	3	12.5	SPAV.13022 KR	37.5	190	29	14	SPAV.13023 KR	29.5	195	27	19	●	PVC
13	3	12.5	SPAV.13032 KR	37.5	190	29	14	SPAV.13033 KR	29.5	195	27	19	●	PVC
13	3	12.5	SPAV.13042 KR	37.5	190	29	14	SPAV.13043 KR	29.5	195	27	19	●	PVC

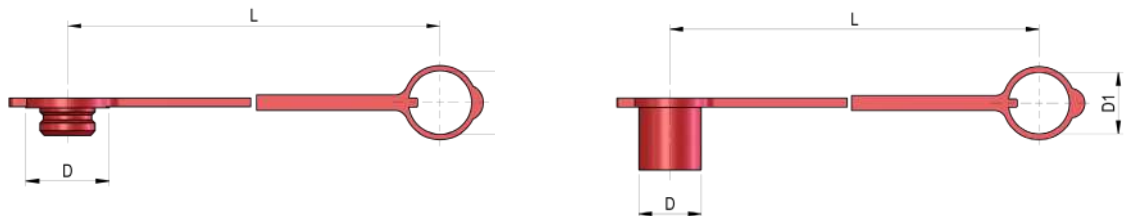

METAL CAPS

NOMINAL SIZE			FEMALE DUST PLUG					MALE DUST CAP					MATERIAL
DNP	BG	ISO	COD. F	Dimensions			Weight (g)	COD. M	Dimensions			Weight (g)	
				D	L	D1			D	L	D1		
13	3	12.5	SPAV.13202	38	205	32	51	SPAV.13203	38	205	32	70	Aluminum
20	4	20	SPAV.20202	45	275	47	66	SPAV.20203	45	275	47	107	Aluminum

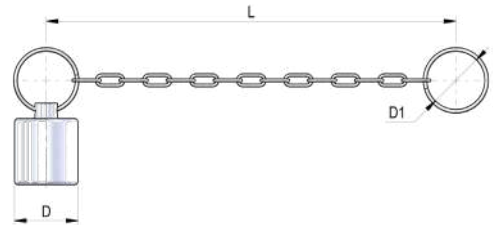
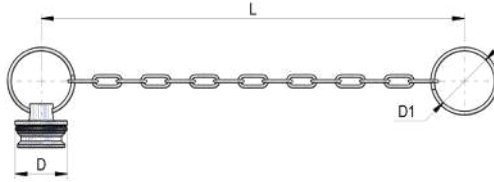

SPARE PARTS

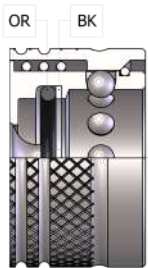

NOMINAL SIZE			FEMALE GASKET	
DNP	BG	ISO	OR (NBR*)	BK (PTFE)
13	3	12.5	PAV.013.120	PAV.013.130
20	4	20	PAV.019.120	PAV.019.130

*AL CODICE DELLA GUARNIZIONE IN NBR AGGIUNGERE 'E' PER EPDM O 'V' PER VITON

*TO THE NBR GASKET CODE ADD 'E' FOR EPDM OR 'V' FOR VITON

*ZU DER ARTIKELNR. DER NBR DICHTUNG GEBEN SIE 'E' FUER EPDM ODER 'V' FUER VITON AN

*AU CODE DU JOINT EN NBR JOINDRE 'E' POUR EPDM OU 'V' POUR VITON